

Osceola (Yaholi) - Winterset (Madison County) 161 kV Transmission Line Project

PROJECT OVERVIEW

Due to a change in the proposed project route and in coordination with the additional public information meetings held on November 12, 2024, for a segment of the Osceola-Winterset project, ITC Midwest has updated the project profiles, maps and other relevant information below.

ITC Midwest (ITC) is planning to build a new 161 kV (161,000 volt) electric transmission line that travels through Madison and Clarke counties from the Winterset Substation, owned by CIPCO, to the Alliant Energy and ITC Midwest Yaholi Substation in Osceola. Altogether through the two counties, the proposed line is approximately 28.6 miles long. The segment in Madison County is approximately 13.5 miles. The final route may change and will be determined when easement negotiations with landowners are completed and the Iowa Utilities Commission has approved the project. (Please see map of the proposed line route corridor in Madison County on the back.)

Why is this line needed?

This line build is part of ITC Midwest's continuing efforts to improve reliability of the electric transmission system and better serve current and future needs of electric consumers. The configuration of the existing transmission system in the area limits the ability to re-route electricity to customers during planned outages (when a line need to be taken out of service for maintenance) and unplanned outages (such as an outage resulting from a severe storm). This new 161 kV line is needed to ensure the system can continue to remain reliable during planned and unplanned system outages. Connecting an additional 161 kV line to the transmission grid in this area ensures long-term reliability can be maintained as well as providing increased system resiliency to better withstand severe weather.

The Osceola (Yaholi) - Winterset project will provide important benefits and drive value for electric consumers. When completed, this transmission line will:

- Increase transmission infrastructure to **improve system reliability**
- Enhance grid resilience to better **withstand extreme weather**
- **Better serve current and future needs** through increased system capacity
- **Reduce electric system congestion** and improve grid efficiency

Whose approval is required to build this line?

The Iowa Utilities Commission (IUC) grants regulatory approvals, called franchises, to Iowa utilities seeking to build transmission lines in the state. As part of its review process, the IUC reviews many aspects of the project such as the need for the line and the proposed route. The IUC has very clear criteria and a clear process for utilities to follow to request a franchise.

What is being done to ensure this line will be safe?

This line will be designed to meet and even exceed the National Electrical Safety Code (NESC), the nationally-recognized design standard in the United States, as well as the Iowa Electrical Safety Code. Among other things, these codes require construction to meet clearance requirements and withstand extreme weather conditions. As the line owner, ITC Midwest will make sure that the line is clear of trees and other vegetation.



FOR THE GREATER GRID.

ITC MIDWEST 3165 Edgewood Parkway SW, Cedar Rapids, IA 52404
Locations: Albert Lea, Des Moines, Dubuque, Iowa City, Lakefield, Perry
877.ITC.ITC9 (877.482.4829) | www.itcmidwest.com

Osceola (Yaholi) - Winterset (Madison County) 161 kV Transmission Line Project

What is ITC Midwest doing to minimize impact on landowners and current land uses?

ITC Midwest seeks to minimize the impact of the line on existing land uses. The company is committed to protecting the environment and will fully compensate landowners for any damages that occur during the construction process.

Where possible, this new line will be double-circuited with existing transmission lines to mitigate the need for a new transmission corridor across privately owned land. To minimize the footprint of the line, ITC Midwest plans to use steel monopoles.

How will ITC Midwest work with landowners?

Under Iowa law, ITC Midwest cannot negotiate for easements until after the Iowa Utilities Commission holds a public information meeting. For this project, the Madison County meeting was held in St. Charles on November 12, 2024. In the coming weeks, ITC Midwest representatives will begin meeting with affected landowners in the proposed corridor to explain the process and their rights, and ultimately, to begin negotiations to secure voluntary easements. Landowners are compensated for permitting ITC Midwest to secure an easement on their property. ITC Midwest understands and appreciates the impact that new line construction has on landowners and pledges to treat *all* landowners with the utmost respect during this important process.

Osceola (Yaholi) - Winterset project proposed line corridor route in Madison County

LEGEND

-  Proposed 161kV Transmission Line - ITC
-  Proposed Double Circuit 161kV/161kV Transmission Line - ITC/MEC
-  Winterset Substation - CIPCO
-  Notification Corridor
-  Public Lands/Wildlife Management Area (WMA)
-  Section Line
-  Hydrology
-  Bridges
-  Roads
-  County Highway

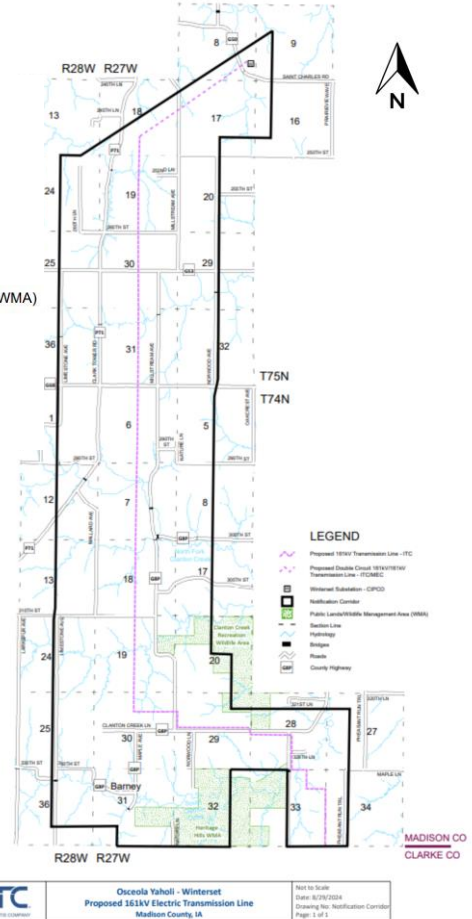

Project Contacts

If you have questions, you can contact ITC using our toll-free customer line at 1-877-482-4829. Once construction begins, Sheri Carter and Andy DeVaul will be ITC Midwest's project leads.



Sheri Carter
Project Manager
(319) 297-6813
scarter@itctransco.com



Andy DeVaul
Field Supervisor
(641) 328-9894
adevail@itctransco.com