

# Osceola (Yaholi) - Winterset (Clarke County) 161 kV Transmission Line Project



## PROJECT OVERVIEW

ITC Midwest (ITC) is planning to build a new 161 kV (161,000 volt) electric transmission line that travels through Madison and Clark counties from the Winterset Substation, owned by CIPCO, to the planned Yaholi Substation, currently being constructed by Alliant Energy and ITC Midwest in Osceola.

In Clarke County the line starts at the Clarke/ Madison County line, just west of 110 Avenue and runs south for approximately 1.0 mile. The proposed line travels eastwardly for 0.25 miles, then turns south for approximately 2.5 miles, running along 110<sup>th</sup> Avenue. The proposed line travels east for about 3.5 miles and then south for about 1.6 miles. Just south of Nature Street and west of the CIPCO Murray Junction Substation, the proposed line travels southeast for 5.5 miles and then east for approximately 2.5 miles. Then, the proposed line travels south to the Osceola city limits for approximately 0.5 mile. Altogether, through the two counties the line is approximately 28.5 miles long. The segment in Clarke County is approximately 17.35 miles long. The final route may change and will be determined when easement negotiations with landowners are completed and the Iowa Utilities Board has approved the project. (Please see map of the proposed line route corridor in Clarke County on the back.)

### ***Why is this line needed?***

This line build is part of ITC Midwest's continuing efforts to improve reliability of the electric transmission system and better serve current and future needs of electric consumers. The configuration of the existing transmission system in the area limits the ability to re-route electricity to customers during planned outages (when a line need to be taken out of service for maintenance) and unplanned outages (such as an outage resulting from a severe storm). This new 161 kV line is needed to ensure the system can continue to remain reliable during planned and unplanned system outages. Connecting an additional 161 kV line to the transmission grid in this area ensures long-term reliability can be maintained as well as providing increased system resiliency to better withstand severe weather.

### **The Osceola (Yaholi) - Winterset project will provide important benefits and drive value for electric consumers. When completed, this transmission line will:**

- Increase transmission infrastructure to **improve system reliability**
- Enhance grid resilience to better **withstand extreme weather**
- **Better serve current and future needs** through increased system capacity
- **Reduce electric system congestion** and improve grid efficiency

### ***Whose approval is required to build this line?***

The Iowa Utilities Board (IUB) grants regulatory approvals, called franchises, to Iowa utilities seeking to build transmission lines in the state. As part of its review process, the IUB reviews many aspects of the project such as the need for the line and the proposed route. The IUB has very clear criteria and a clear process for utilities to follow to request a franchise.

### ***What is being done to ensure this line will be safe?***

This line will be designed to meet and even exceed the National Electrical Safety Code (NESC), the nationally-recognized design standard in the United States, as well as the Iowa Electrical Safety Code. Among other things, these codes require construction to meet clearance requirements and withstand extreme weather conditions. As the line owner, ITC Midwest will make sure that the line is clear of trees and other vegetation.

## Osceola (Yaholi) - Winterset (Clarke County) 161 kV Transmission Line Project

### **What is ITC Midwest doing to minimize impact on landowners and current land uses?**

ITC Midwest seeks to minimize the impact of the line on existing land uses. The company is committed to protecting the environment and will fully compensate landowners for any damages that occur during the construction process.

Where possible, this new line will be double-circuitured with existing transmission lines to mitigate the need for a new transmission corridor across privately owned land. To minimize the footprint of the line, ITC Midwest plans to use steel monopoles.

### **How will ITC Midwest work with landowners?**

Under Iowa law, ITC Midwest cannot negotiate for easements until after the Iowa Utilities Board holds a public information meeting. For this project, the Clarke County meeting was held in Osceola on July 19, 2023. In the coming weeks, ITC Midwest representatives will begin meeting with affected landowners in the proposed corridor to explain the process and their rights, and ultimately, to begin negotiations to secure voluntary easements. Landowners are compensated for permitting ITC Midwest to secure an easement on their property. ITC Midwest understands and appreciates the impact that new line construction has on landowners and pledges to treat *all* landowners with the utmost respect during this important process.

## Osceola (Yaholi) - Winterset project proposed line corridor route in Clarke County

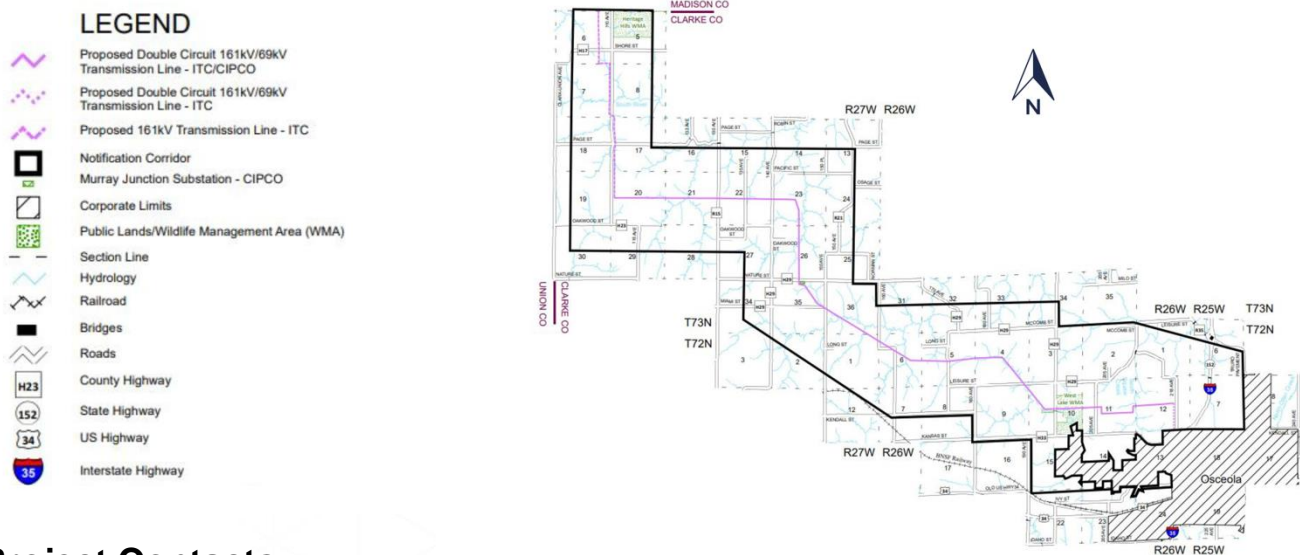

## Project Contacts

If you have questions, you can contact ITC using our toll-free customer line at 1-877-482-4829. Once construction begins, Sheri Carter and Ian Buschbom will be ITC Midwest's project leads.



**Sheri Carter**  
Project Manager  
(319) 297-6813  
[scarter@itctransco.com](mailto:scarter@itctransco.com)



**Ian Buschbom**  
Field Supervisor  
(641) 750-6924  
[ibuschbom@itctransco.com](mailto:ibuschbom@itctransco.com)